

# RGP-30



## APPLICATION

Sealed large-stroke gripper for handling large parts and high part variety.

## TYPE

Available in sizes 30, 40 and 50 with integrated seal - optionally with gripping force securing device.  
High precision thanks to double-piston drive synchronized via gear wheel.

## CUSTOMER BENEFITS

- ⊕ High gripping force with simultaneously high jaw stroke by means of double-acting pressure pistons
- ⊕ High torque support for using long gripper fingers thanks to elongated jaw guide
- ⊕ Sealed for rough ambient conditions with quad-ring seal and highly precise intermediate jaws
- ⊕ Maximum flexibility thanks to versatile connection and fastening options

## TECHNICAL FEATURES

- Centrally clamping in compact design made of high-strength, hard-coated aluminum alloy
- All functional parts made of hardened steel for maximum service life
- Optional inductive and magnetic position sensors
- Optionally available with FKM seals for higher temperatures up to 150°C (on request)
- Integrated purge air connection to prevent contamination

C40

RGP-30 - 2-jaw long stroke gripper air operated

Item no.	170109	170110
Design	RGF 30	RGF 30 GA
Gripping force at 6 bar N	630	720
Stroke per jaw mm	30	30
Gripping force maintained N	-	90
Recommended workpiece weight kg	3	3
Weight kg	3,2	3,2
Width mm	134	134
Height mm	66	66
Depth mm	94	94
Mx Nm	30	30
My Nm	95	95
Mz Nm	45	45
Fz N	1000	1000
Operating pressure min./max. without GA/GI bar	2-8	-
Operating pressure min./max. with GA/GI bar	-	5-6,5
Clamping time s	0,3	0,35
Opening time s	0,3	0,35
Air consumption per cycle cm <sup>3</sup>	92	92
Max. allowable length of jaw mm	150	100

# RGP-30

Max. load on gripper and jaw

Clamping force diagram

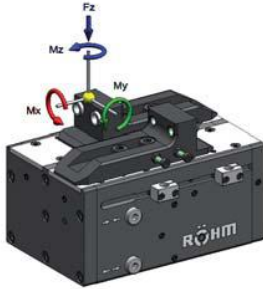

Clamping force diagram – exterior gripping

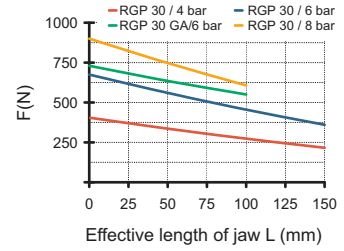

Clamping force diagram – interior gripping

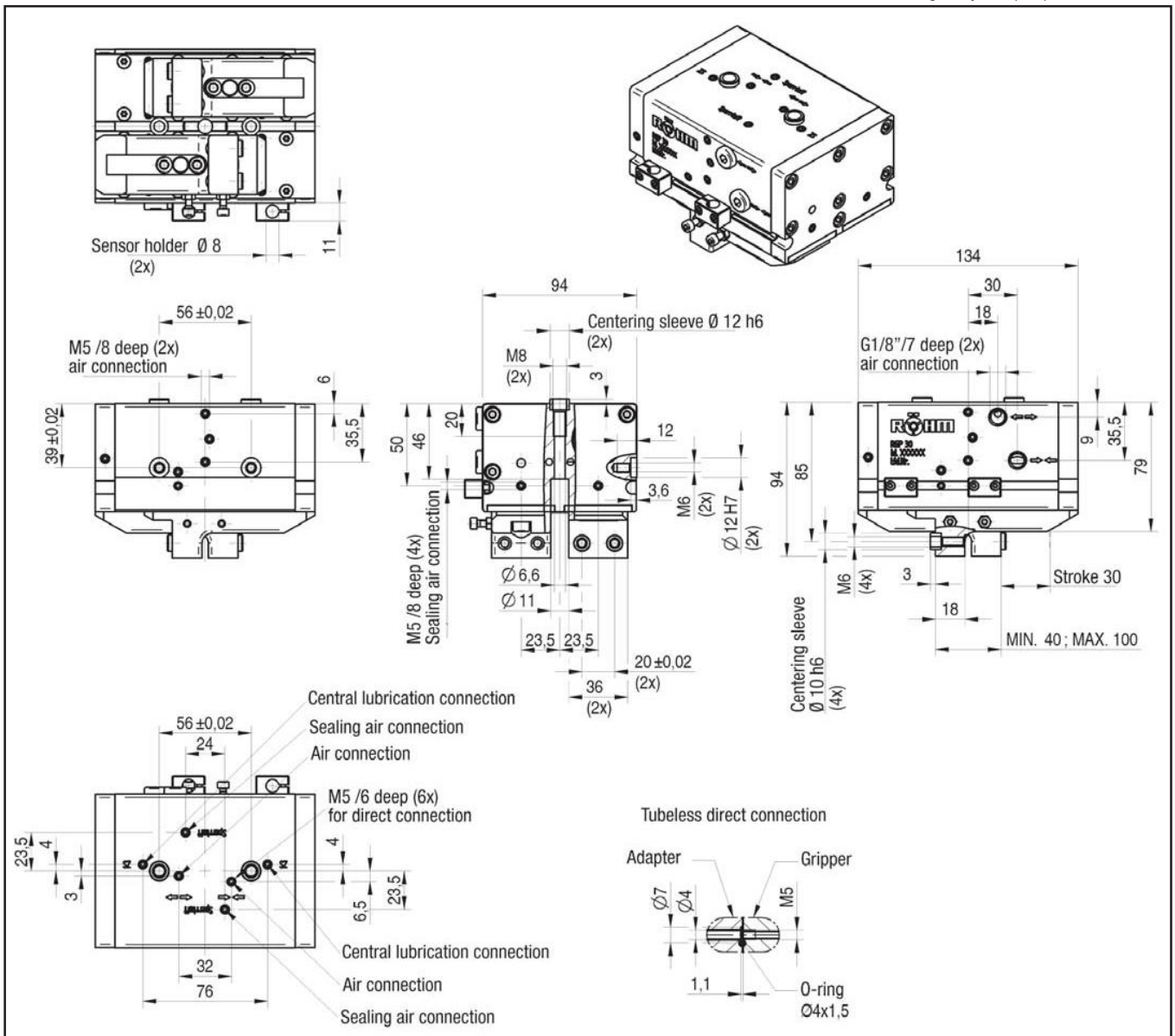
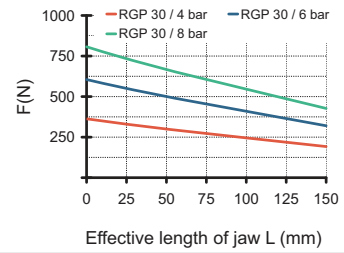

Long stroke gripper RGP

# RGP-40



## APPLICATION

Sealed large-stroke gripper for handling large parts and high part variety.

## TYPE

Available in sizes 30, 40 and 50 with integrated seal - optionally with gripping force securing device.  
High precision thanks to double-piston drive synchronized via gear wheel.

## CUSTOMER BENEFITS

- ③ High gripping force with simultaneously high jaw stroke by means of double-acting pressure pistons
- ③ High torque support for using long gripper fingers thanks to elongated jaw guide
- ③ Sealed for rough ambient conditions with quad-ring seal and highly precise intermediate jaws
- ③ Maximum flexibility thanks to versatile connection and fastening options

## TECHNICAL FEATURES

- Centrally clamping in compact design made of high-strength, hard-coated aluminum alloy
- All functional parts made of hardened steel for maximum service life
- Optional inductive and magnetic position sensors
- Optionally available with FKM seals for higher temperatures up to 150°C (on request)
- Integrated purge air connection to prevent contamination

C40  
RGP-40 - 2-jaw long stroke gripper air operated

Item no.	170111	170112	170113
Design	RGP 40	RGP 40-GA	RGP 40-GI
Gripping force at 6 bar N	1260	1540	1380
Stroke per jaw mm	40	40	40
Gripping force maintained N	-	150	150
Recommended workpiece weight kg	6,3	6,3	5,5
Weight kg	5,6	5,6	5,6
Width mm	171	171	171
Height mm	83	83	83
Depth mm	115	115	115
Mx Nm	50	50	50
My Nm	100	100	100
Mz Nm	70	70	70
Fz N	1100	1100	1100
Operating pressure min./max. without GA/GI bar	2-8	-	-
Operating pressure min./max. with GA/GI bar	-	5-6,5	5-6,5
Clamping time s	0,3	0,3	0,4
Opening time s	0,3	0,4	0,3
Air consumption per cycle cm <sup>3</sup>	240	240	240
Max. allowable length of jaw mm	200	150	150

# RGP-40

Max. load on gripper and jaw

Clamping force diagram

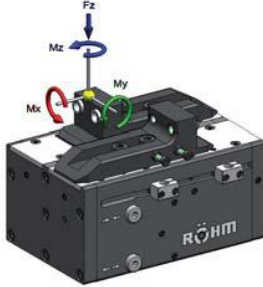

Clamping force diagram – exterior gripping

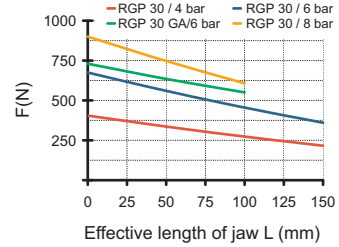

Clamping force diagram – interior gripping

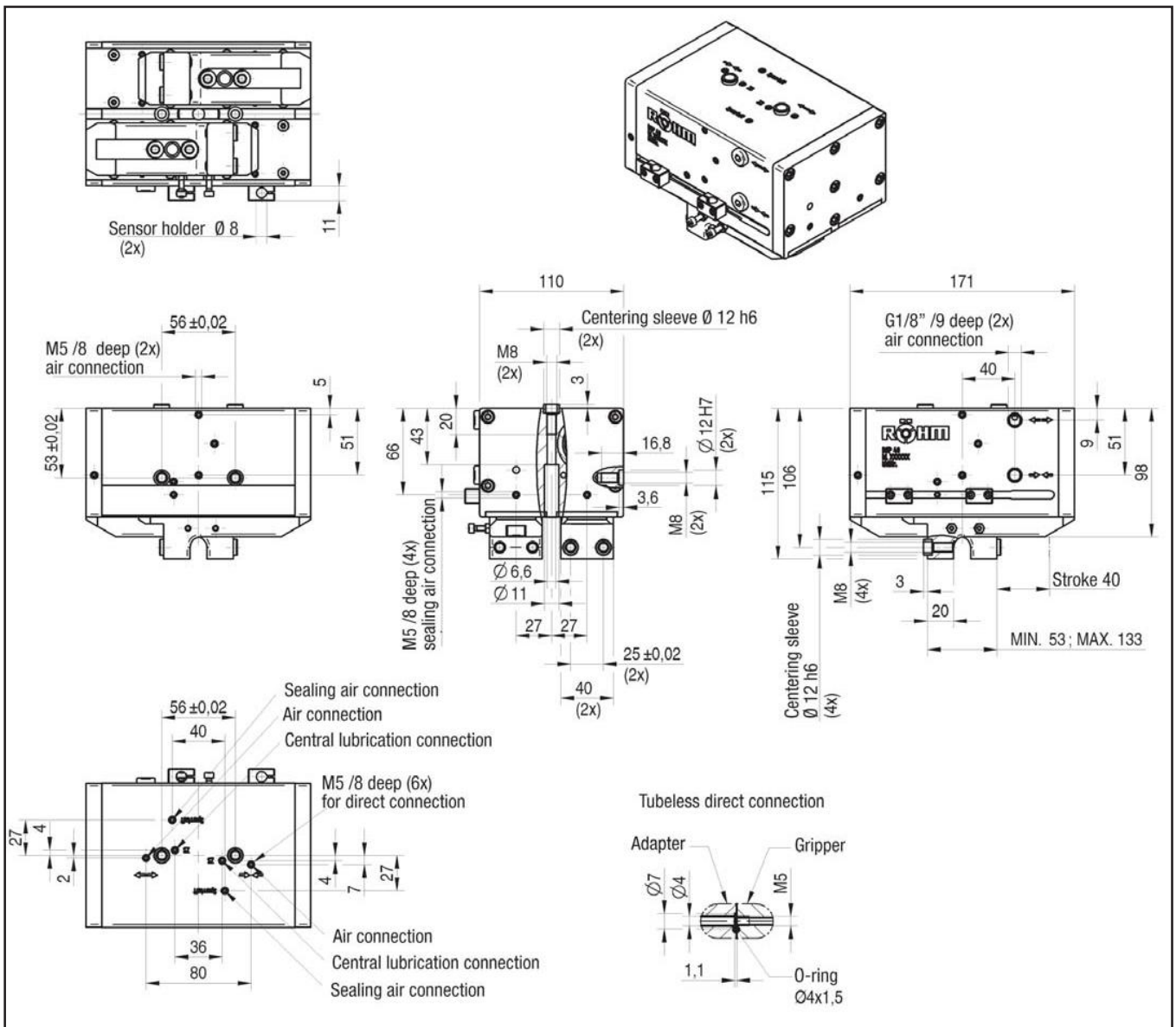
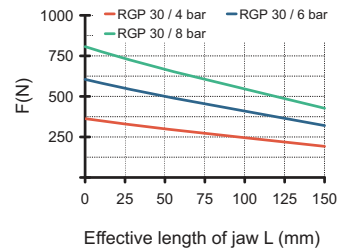

Long stroke gripper RGP

# RGP-50



## APPLICATION

Sealed large-stroke gripper for handling large parts and high part variety.

## TYPE

Available in sizes 30, 40 and 50 with integrated seal - optionally with gripping force securing device.  
High precision thanks to double-piston drive synchronized via gear wheel.

## CUSTOMER BENEFITS

- ③ High gripping force with simultaneously high jaw stroke by means of double-acting pressure pistons
- ③ High torque support for using long gripper fingers thanks to elongated jaw guide
- ③ Sealed for rough ambient conditions with quad-ring seal and highly precise intermediate jaws
- ③ Maximum flexibility thanks to versatile connection and fastening options

## TECHNICAL FEATURES

- Centrally clamping in compact design made of high-strength, hard-coated aluminum alloy
- All functional parts made of hardened steel for maximum service life
- Optional inductive and magnetic position sensors
- Optionally available with FKM seals for higher temperatures up to 150°C (on request)
- Integrated purge air connection to prevent contamination

C40  
RGP-50 - 2-jaw long stroke gripper air operated

Item no.	170114	170115	170116
Design	RGP 50	RGP 50-GA	RGP 50-GI
Gripping force at 6 bar N	2600	2950	2680
Stroke per jaw mm	50	50	50
Gripping force maintained N	-	450	450
Recommended workpiece weight kg	13	13	11,5
Weight kg	11	11	11
Width mm	218	218	218
Height mm	103	103	103
Depth mm	141	141	141
Mx Nm	60	60	60
My Nm	100	100	100
Mz Nm	80	80	80
Fz N	1300	1300	1300
Operating pressure min./max. without GA/GI bar	2-8	-	-
Operating pressure min./max. with GA/GI bar	-	5-6,5	5-6,5
Clamping time s	0,6	0,5	0,7
Opening time s	0,7	0,8	0,6
Air consumption per cycle cm <sup>3</sup>	600	600	600
Max. allowable length of jaw mm	250	200	200

# RGP-50

Max. load on gripper and jaw

Clamping force diagram

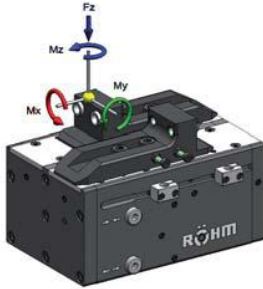

Clamping force diagram – exterior gripping

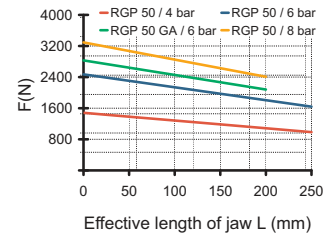

Clamping force diagram – interior gripping

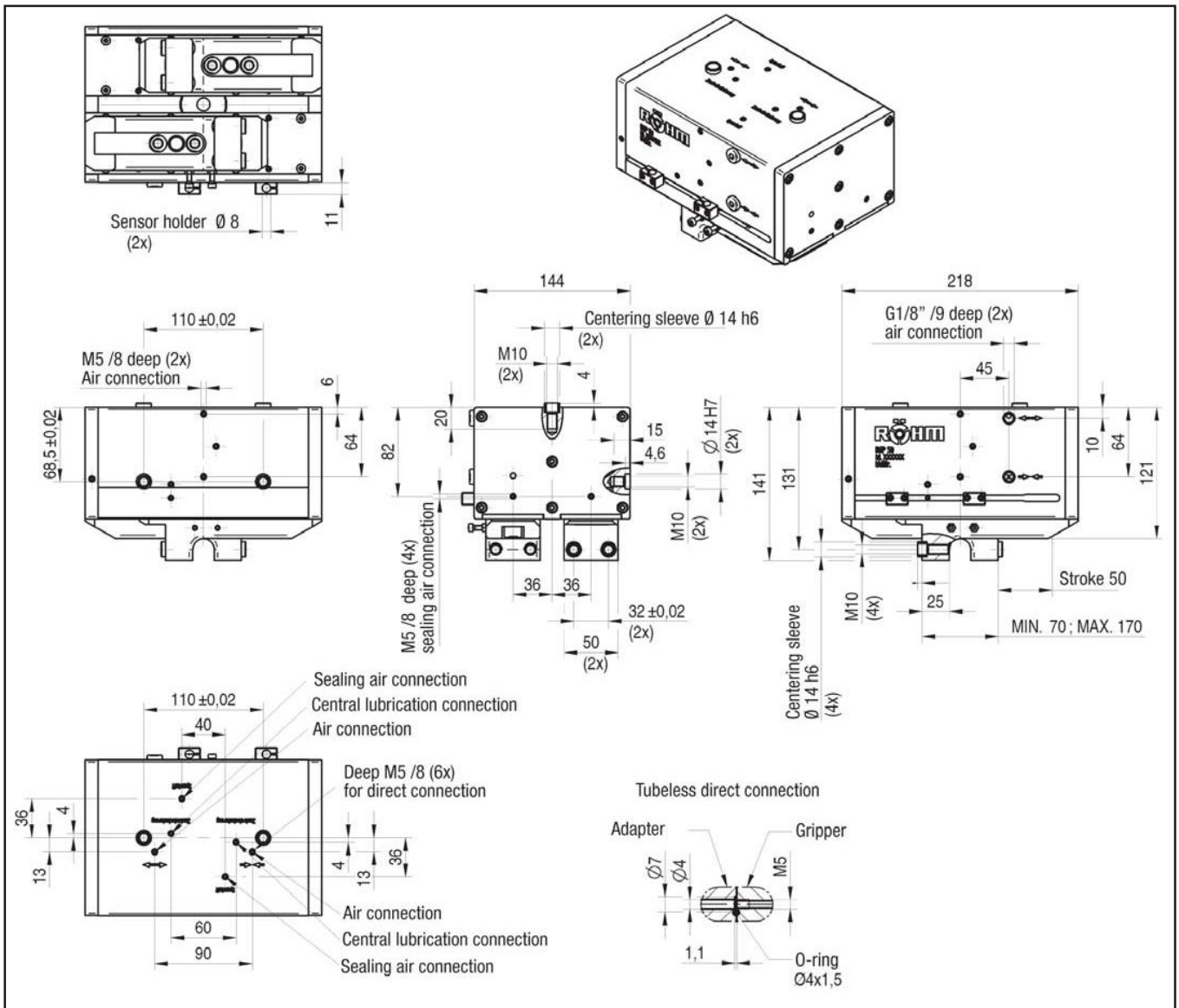
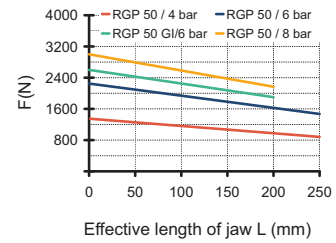

Long stroke gripper RGP

# Accessories RGP

**Intermediate jaw - steel** (including fixing screws)  
2-jaw set



Item no.	Number of jaws	Design	For
170993 ▲	2	steel	RGP-30
170995 ▲	2	steel	RGP-40
170997 ▲	2	steel	RGP-50

**Jaw blank - steel** (including fixing screws)  
2-jaw set



Item no.	Number of jaws	Design	For
1146146 ▲	2	aluminium	RGP-30
1146144 ▲	2	aluminium	RGP-40
1131198 ▲	2	aluminium	RGP-50

**Pressure maintenance**  
for double acting gripper (G1/8)



Item no.
1078823

**Compressed air connection - L-Plug connector**



Item no.	Design	For
477025	L-Plug connector 1/8 - 6 mm	all sizes, all types

**Proximity switch**



Item no.	Size (diameter/length)	Design	For
229114	M8x1x30,5	5 m cable, open leads	all sizes, all types

**Magnetic field sensors**



Item no.	Size (diameter/length)	Design	For
1276722	C-Nut	3m cable, 3 open leads	all sizes, all types

# Accessories RGP

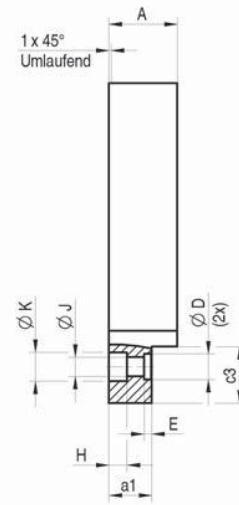
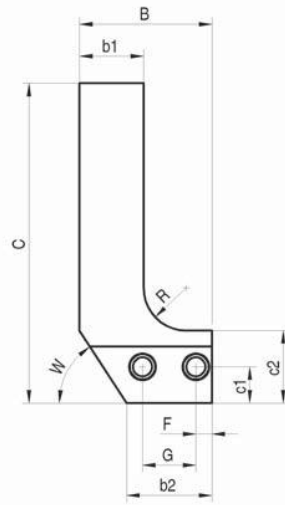

Jaw blank - steel (including fixing screws)

RGP Jaw blank - steel	30	40	50
RGP - 2-jaw set	1146146	1146144	1131198
A	28	32	42
a1	18	20	25
B	54	62	80
b1	25	30	38
b2	36	40	50
C	100	150	200
c1	13	17	22
c2	30	34	40
c3	22,5	26,5	32,5
D+0,02/+0,04	10	12	14
E+0,02	3,6	3,6	4,6
F±0,1	8	7,5	9
G±0,02	20	25	32
H	6,8	8,5	11
J	6,6	9	11
K	11	13,5	16,5
R	15	20	25
W	57°	57°	57°
Weight per jaw Kg	0,6	1,2	2,6



# Accessories RGP

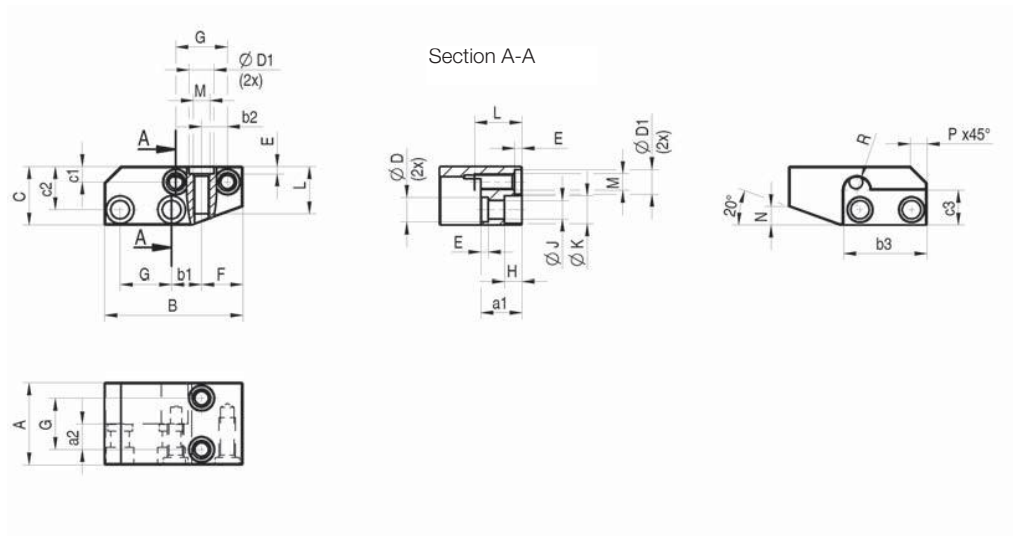

Intermediate jaw - steel (including fixing screws)

	30	40	50
RGP Intermediate jaw - steel			
RGP - 2-jaw set	170993	170995	170997
A	36	40	50
a1	18	20	25
a2	10	12,5	16
B	59,5	67	86
b1	13,5	14,5	20
b2	10	12,5	16
b3	36,5	40,5	50,5
C	26,5	28,5	35
c1	8	7,5	9
c2	20	21	25
c3	16	17	20,5
D+0,02/+0,04	10	12	14
E+0,02	3,5	3,5	4,6
F±0,1	18	20	25
G±0,02	20	25	32
H	6,8	8,5	11
J	6,6	9	11
K	11	13,5	16,5
L	18	23	28
M	M6	M8	M10
Nx20°	8	9	12
Px45°	7	8	10
R	5,5	6,5	6,5
Weight per jaw Kg	0,6	1,2	2,6
Centering sleeve	170264	170265	170266
Size	Ø10	Ø12	Ø14

Accessories RGP