



APPLICATION

Particularly suitable for use on machining centers.

TYPE

Size 92 - clamping system mechanical-hydraulic with power transmitter, manually operated.

Size 125, 160 and 200 - clamping system mechanical-mechanical with power transmitter, manually operated.

CUSTOMER BENEFITS

- ⊕ Horizontal, side or in connection with a base plate vertical mounting, for example as DUO clamping tower (back to back)
- ⊕ Sturdy chip protection prevents chips from penetrating
- ⊕ Drive spindle with clamping force presetting
- ⊕ Clamping surface for clamping claws
- ⊕ Central lubrication of guides and spindle thread
- ⊕ Thread for fastening angle drive

TECHNICAL FEATURES

- Sturdy steel body and all guides are hardened and ground on all sides
- Long clamping slide with cross slots, hardened on all sides, functional surfaces ground
- Threaded bores for taking up all RÖHM flat clamping jaws with jaw width 125/160 mm

A32
RKE with stepped jaws

Item no.	178411	178412	178413	178414
Jaw width A mm	92	125	160	200
Jaw design	stepped jaws	stepped jaws	stepped jaws	stepped jaws
B2 mm	0 - 138	0 - 216	0 - 320	0 - 315
B3 mm	71 - 208	97 - 312	131 - 451	131 - 451
C mm	32	40	50	60
D mm	330	463	618	618
E mm	112	140	165	175
F mm	276	400	530	530
G-0,02 mm	80	100	115	115
H2 mm	80	112,5	130	135
H3 mm	41	56,5	64	64
J2 mm	56	70	97	97
K mm	94	126	162	162
L2 mm	64	94	98	103
M mm	25	40	34	39
M* mm	25	30	32,5	32,5
N-0,01 mm	16	20	25	25
U mm	20	20	20	20
V mm	12	12	12	12
W mm	68	1x108	2x102,5	2x102,5
X mm	10	10	10	10
Y mm	15	15	15	15
Z mm	70	109	117	117
a mm	63	80	100	125
b mm	13,6	15,6	19,6	24,6
c1	M 6x14	M 8x14	M 8x14	M 10x15
c2	M 5x9	M 5x10	M 5x9	M 5x10
c3	M 10x16	M 10x18	M 10x18	M 14x20
d mm	48	60	80	110
e mm	8	12	12	12
f mm	14	18	20	25
g mm	70	95	125	125
Ø k	M10x18	M12x22	M16x25	M16x25
l mm	140	240	200	200
m2±0,02 mm	60	127,5	70	65
n±0,02 mm	99	183,5	136	136
y+0,01 mm	40	47,5	57,5	57,5
z mm	72	100	135	135
Clamping force kN	25	40	60	60
Weight kg	15	41	79	85



NC-Compact vices
RKE

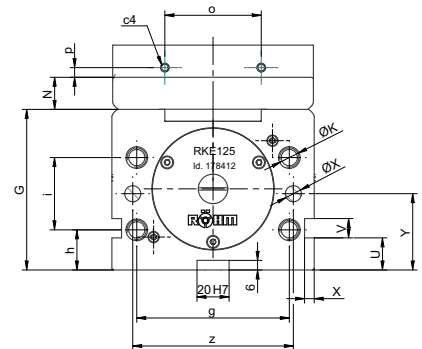
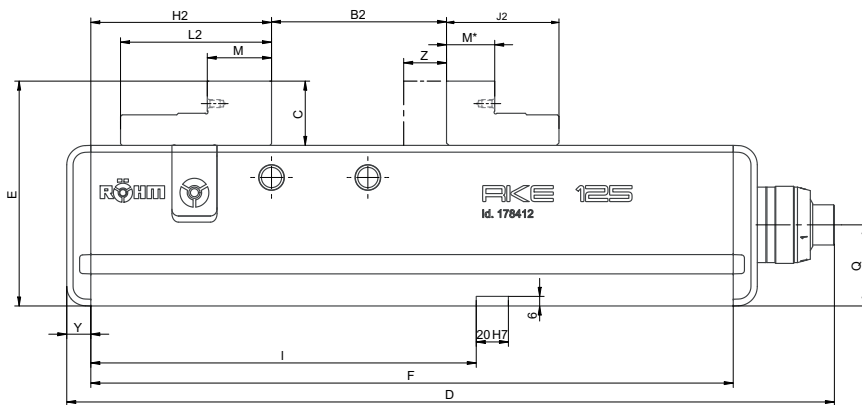
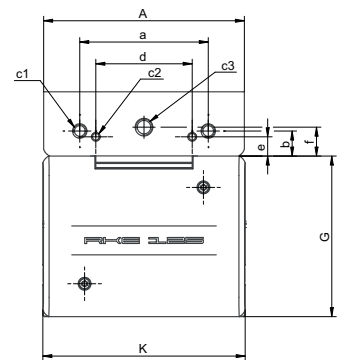
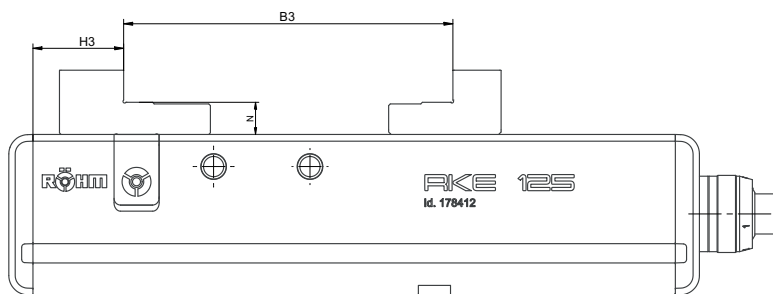

Accessories RKE

A37
Standard top jaws SA, reversible

Item no.	Contents of delivery	Size	Width mm	Height mm
162628	set	125	125	40
162629	set	160	160	50
162984	set	200	200	60



A37
Stepped jaws SB, reversible

Item no.	Contents of delivery	Size	Width mm	Height mm
178776	set	92	92	32
178230	set	125	125	40
178754	set	160	160	50
178937	set	200	200	60



A37
Double stepped jaws DSB, "smooth"

Item no.	Contents of delivery	Size	Width mm	Height mm
168698	set	92	50	48
168693	set	125	62	60
175387	set	160	95	75



A37
Carrier jaws TB, without swivelling claw inserts

Item no.	Contents of delivery	Size	Width mm	Height mm
165856	set	125	125	20
166218	set	160/200	160	25



A37
Carrier jaws, without claw inserts

Item no.	Contents of delivery	Size	Width mm	Height mm
169383	set	92	115	20
165861	set	125	160	20
166223	set	160/200	200	25



A37
Swivelling claw inserts for carrier jaws 743-72

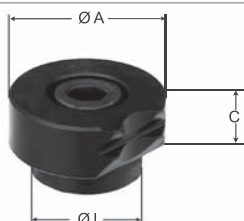

Item no.	Contents of delivery	Size	Ø A mm	Ø J mm	C mm
165854	piece	92/125	28	20	10
166216	piece	160/200	30	22	10

Accessories RKE

A37
Tensioner for carrier jaws 743-72

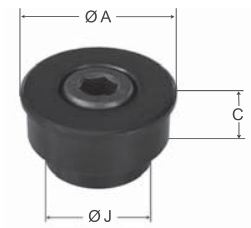

Item no.	Contents of delivery	Size	Ø A mm	Ø J mm	C mm
169389	piece	92/125	28	20	10
169391	piece	160/200	30	22	10

A37
One-piece steel top jaws, for self-production of formed jaws, or for clamping formed parts



Item no.	Contents of delivery	Size	Width mm	Height mm
160352	set	125	125	60
160353	set	160	160	70

A37
Normal jaw SGN, one side smooth, one side grooved, both sides ground



Item no.	Contents of delivery	Size	Width mm	Height mm
152752	piece	92	92	31,6
178112	piece	125	125	39,7
152755	piece	160	160	49,6
152759	piece	200	200	62,6

A37
Normal jaw finely checkered SGNf, reversible, to increase the specific contact pressure (higher holding forces), one side finely checkered, one side longitudinally grooved



Item no.	Contents of delivery	Size	Width mm	Height mm
163218	piece	92	92	31,6
180679	piece	125	125	39,7
156197	piece	160	160	49,6
156198	piece	200	200	62,6

A37
Claw jaws with fine step, 2.5 mm clamping depth



Item no.	Contents of delivery	Size	Width mm	Height mm	Thickness mm
166514	set	125	92	32	14
166520	set	160	125	40	16
166522	set	200	160	50	18

Accessories NC-Compact vices RKE

Accessories RKE

A37

Claw jaws without step, universal for clamping depth > 2.5 mm



Item no.	Contents of delivery	Size	Width mm	Height mm	Thickness mm
166661	set	125	92	32	14
166667	set	160	125	40	16
166669	set	200	160	50	18

A37

Support rails Cliparc, set with 10 different pairs of rails and 4 clamps in wooden box



Item no.	Web height A mm	Jaw width B mm	Rail height H mm	Guiding width C mm	Spare clamp (Set = 4 pieces)
1269621	48	92	10/16/18/20/23/25/26/27/28/29	94	1269624
1269622	68	125	10/15/20/25/28/30/33/35/36/37	126	1269625
1269623	83	160/200	10/15/20/25/30/35/40/43/45/47	162	1269626

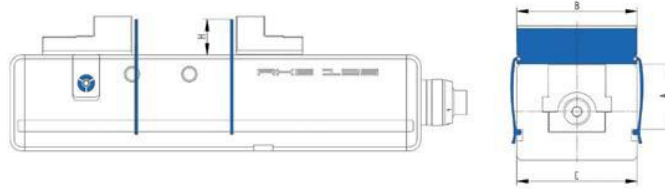

Accessories NC-Compact vices RKE

A37

V-jaw SPR, with vertically and horizontally ground-in prisms, hardened, for combination with SGN, only suitable for double clamping



Item no.	Contents of delivery	Size	Width mm	Height mm	Chucking capacity mm	
					Horizontal	Vertical
128770	piece	92	92	31,6	3-13	5-32
082363	piece	125	135	39,6	4-20	6-40
082364	piece	160	160	49,6	5-29	7-48
082365	piece	200	200	62,6	6-37	8-56

A37

Normal jaw SGN, with movable workpiece stop, hardened and ground, only suitable for double clamping



Item no.	Contents of delivery	Width mm	Height mm
150740	piece	135	39,6
150741	piece	160	49,6

A37

Draw-down jaws SNF, with spring plate, hardened and ground



Item no.	Contents of delivery	Size	Width mm	Height mm
077105	set	125	135	39,6
077106	set	160	160	49,6
077107	set	200	200	62,6

A37

V-jaw and standard jaw SBO, unhardened and burnished, with workpiece support



Item no.	Contents of delivery	Width mm	Height mm	Chucking capacity mm	
				Horizontal	Vertical
317260	set	135	39,8	3-13	6-40
317261	set	160	49,8	5-22	7-48

Accessories RKE

A37
Draw-down jaws RKG, with two permanent magnets



Item no.	Contents of delivery	Size	Width mm	Height mm
155237	set	92	92	32
159227	set	125	125	39,5
155240	set	160	160	50
163782	set	200	200	60

A37
Standard insert RNS, held by two permanent magnets



Item no.	Contents of delivery	Size	Width mm	C mm	Y mm
155242	set	92	92	32	21
159232	set	125	125	40	26
155245	set	160	160	50	30
163783	set	200	200	60	34

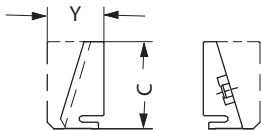

A37
Standard insert finely checkered RNSf, held by two permanent magnets



Item no.	Contents of delivery	Size	Width mm	C mm	Y mm
163270	set	92	92	32	21
163267	set	125	125	40	26
163273	set	160	160	50	30
163784	set	200	200	60	34

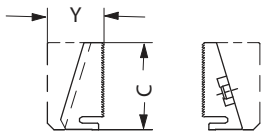

A37
Claw insert RNK, held by two permanent magnets



Item no.	Contents of delivery	Size	Width mm	C mm	Y mm
155247	set	92	92	32	21
159235	set	125	125	40	26
155250	set	160	160	50	30
163785	set	200	200	60	34

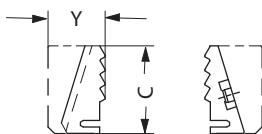

Accessories RKE

A37

Floating jaw horizontal PEB for clamping non-parallel workpieces

Item no.	Contents of delivery	Size	Width mm	Height mm	Thickness mm
156190	piece	92	113	32	36
156191	piece	125	135	40	40
156192	piece	160	160	50	45
156193	piece	200	200	63	55

A37

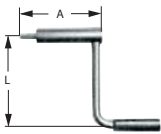
Hand crank, turnable handle, hexagon socket

Item no.	Contents of delivery	Size	Hexagon	A mm	L mm
134198	piece	92	12	60	90
134600	piece	125/160/200	14	104	160

Accessories NC-Compact vices RKE

A37

Angle drive 90°

Item no.	Contents of delivery	Size	A mm	B mm	C mm
154185	piece	92	113,5	90	83,5
158339	piece	125	133	106	98
158888	piece	160/200	166	111	98

A37

Single clamp SPE, for mounting vices on end and on the base

Item no.	Contents of delivery	T-slot	Thread
149121	piece	12	M10x50
149122	piece	14	M12x55
149123	piece	16	M12x60
149124	piece	18	M16x60
155722	piece	20	M16x65
151507	piece	22	M16x65

A37

Fixed slot nuts NTS, hardened and ground, with fixing screw

Item no.	Contents of delivery	Size	Length mm
014823	set	20x12	22
014825	set	20x14	25
014827	set	20x16	25
014829	set	20x18	25
014831	set	20x20	22
014833	set	20x22	32