

1. Body
2. Thrust sleeve for steel collets and segment collets. By replacing the thrust sleeve, duo-segment collets can be used
3. Union nut with bayonet lock
4. Protection against torsion for thrust sleeve
 - Adapter fitting must be ordered separately. Suitable for existing draw tube, glue into thrust sleeve
 - Special accessories; are not part of the scope of delivery. The workpiece stop can only be used for segment collets. Order separately: Cap screw or stud bolt with locknut acc. to DIN 55027.
5. Protection against torsion for collet

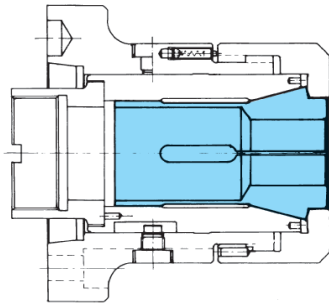

Hollow clamping with steel collet
DIN 6343

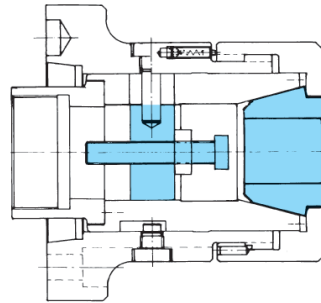

Clamping with segment pliers and
workpiece stop



APPLICATION

External clamping of round workpieces, as well as square and hexagon profiles. Turning, milling, grinding operations as well as for measuring. Ideal for bars and pipe machining on the main spindle. For using standardized DIN collet chucks or segment collet chucks.

TYPE

Force-actuated.
Internal workpiece stop optional in conjunction with segment collet.

CUSTOMER BENEFITS

- ⊕ Light weight and reduced height thanks to compact design
- ⊕ Short setup times thanks to quick change of collet chuck
- ⊕ High flexibility thanks to modular system
- ⊕ Quick retrofitting to other workpieces by changing the collect chuck
- ⊕ Axially stationary collect chuck, no axial tension against internal workpiece stop

TECHNICAL FEATURES

- Hardened, low-wear design
- Either DIN steel or segment collet chucks

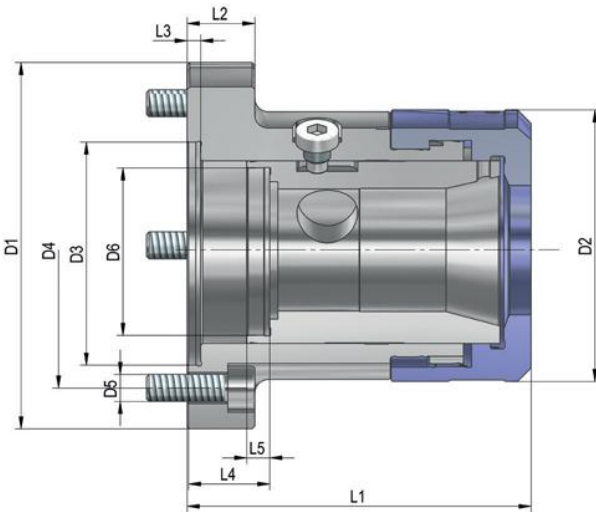

C 15
Power-operated collet chuck KZF, with quick-acting bayonet catch, without collet
Cylindrical center mount / short taper mount - draw tube adapter available on request

Item no.	439989	439990	439991	439992	439993	439994	439995	439996	439997	439998
Size	40	40	40	40	60	60	60	60	80	80
Mount	Z-140	Z-88	KK 5	KK 6	Z-115	Z-170	KK 6	KK 8	Z-130	KK 8
D1	160	135	170	170	157	190	210	210	187	210
D2	100	100	100	100	122	122	122	122	150	150
D3	140	88	82,563	106,375	115	170	106,375	139,719	130	139,719
D4	104,8	115	104,8	133,4	136	133,4	133,4	171,4	166	171,4
D5	4xM10	6xM8	4xM10	4xM12	8xM8	6xM12	4xM12	4xM16	8xM8	4xM16
D6	M66x1,5	M66x1,5	M66x1,5	M66x1,5	M88x1,5	M88x1,5	M88x1,5	M88x1,5	M88x1,5	M114x1,5
L1	116	116	127	128	132	132	144	146	156	170
L2	25	25	25	25	25	25	25	25	30	30
L3	5	5	16	18	5	5	18	22	5	22
L4 min	16	16	32	33	16	16	33	35	17	36
L4 max	8,5	8,5	24,5	25,5	8,5	8,5	25,5	27,5	9,5	28,5
L5	8,5	8,5	8,5	8,5	8,5	8,5	8,5	8,5	12,5	12,5
Total stroke mm	7,5	7,5	7,5	7,5	7,5	7,5	7,5	7,5	7,5	7,5
Maximum draw bar pull kN	25	25	25	25	30	30	30	30	35	35
Total clamping force kN	50	50	50	50	60	60	60	60	70	70
Adm. speed min-1	8000	8000	8000	8000	5000	5000	5000	5000	4000	4000
Chucking capacity mm	2-42	2-42	2-42	2-42	4-60	4-60	4-60	4-60	20-80	20-80
Moment of inertia J kgm ²	0,029	0,029	0,029	0,029	0,038	0,038	0,038	0,038	0,108	0,108
Weight without collet kg	7,1	5,3	7,5	7,5	9,2	9,2	10,2	14	17,5	18

Anti-rotation device optionally available Id.-Nr. 701331

Power-operated collet chuck KZF

KZF-S



APPLICATION

External clamping of round workpieces with smooth or toothed outer geometry for turning, milling, grinding and measuring operations. Optimal on the clamping device/clamping adapted to the workpiece/machining process. Ideal for short clamping lengths.

TYPE

Force-actuated.

CUSTOMER BENEFITS

- ③ Sturdy clamping of the workpiece thanks to axial tension against the workpiece stop
- ③ Quick change of collet chuck by bayonet lock
- ③ High concentricity, axial run-out and repeatability
- ③ High flexibility thanks to modular system

TECHNICAL FEATURES

- Manual lubrication/low-maintenance
- Prepared for internal media feed-through, e.g. air and coolant
- Prepared for internal workpiece stop
- Collet chucks can be individually adapted to the workpiece
- Sealing against chips

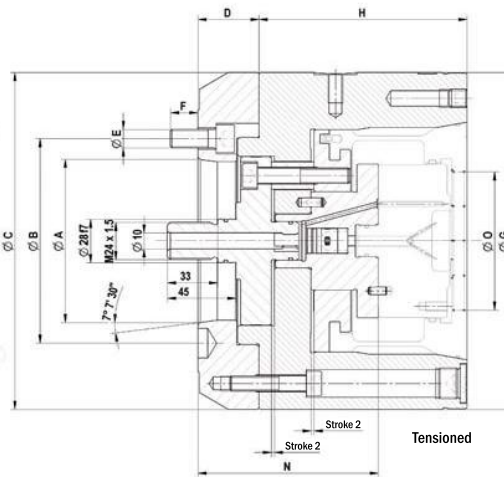
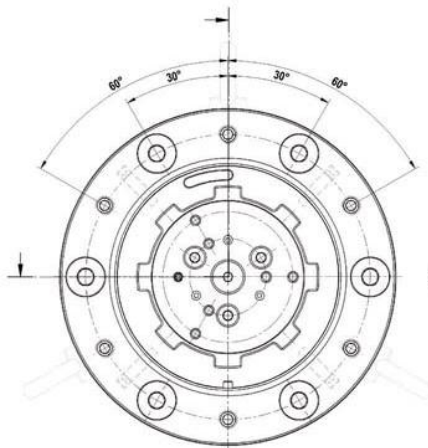

C 18

Power operated collet chuck KZF-S, for external clamping

	KZF 80	KZF 120	KZF 180
Body collet	1117832 ▲	1117830 ▲	1125403 ▲
Base bolt	1117833	1072101	1125404
Draw piece	1117837	1117827	1125408
Fastening plate	1117835	1072105	1125406
Bolt spacer	1117836	1072103	1072103
Ground stop for reverse valve cartridge	1117839	1072113	1125410
Ground stop for ermeto pipe	1117841	1117824	1125412
Reverse valve cartridge 1 Bar	756641	863134	863134
Reverse valve cartridge 3 Bar	843866	889894	889894
A	82,563	106,37	139,719
B	104,8	133,4	171,4
C/G	170	220	258
D	35	40	45
E	M10	M12	M16
F Max, in daN	30	40	40
H	125	136	136
N	103	118	123
O	30-80	60-120	100-180
Speed max, min-1	6000	5000	3500
Stroke mm	4	4	4
Clamping dia, min,	30	60	100
Clamping dia, max,	80	120	180
Expansion in Ø mm	1,4	1,4	1,4
Ø G	170	220	285
H mm	125	136	136

Info: kzf@roehm.biz

Accessories KZF-S

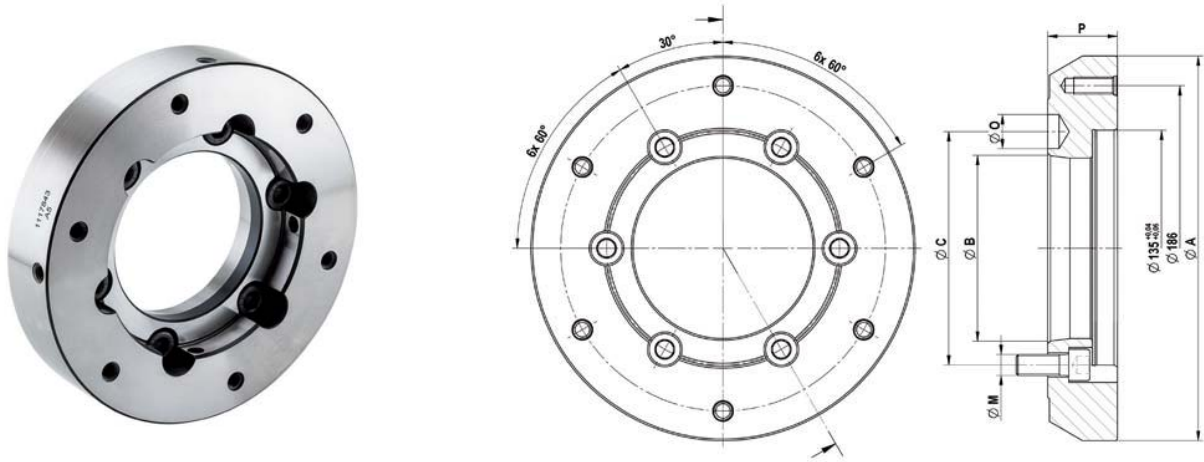

C 18
Intermediate flange ISO 702-1 (DIN 55028)

	A 05	Nr. 5 (A5)	A 05	Nr. 6 (A6)	A 06	A 08	Nr. 8 (A8)	A 08
Intermediate flange	1117843 ▲	1072115	1117845 ▲	1072117	1125416 ▲	1117847 ▲	1072119	1125418 ▲
For	KZF-S 80	KZF-S 80/AGILIS 05-07	KZF-S 81	KZF-S 120/AGILIS 05-07	KZF-S 180	KZF-S 82	KZF-S 120/AGILIS 05-07	KZF-S 180
Short-taper-Ø B	82,563	82,563	106,375	106,375	106,375	139,719	139,719	139,719
Short-taper pitch circle Ø C	104,8	104,8	133,4	133,4	133,4	171,4	171,4	171,4
Flange outer-Ø A	170	220	170	220	285	210	220	285
Ø D	105	135	105	135	200	105	135	200
Ø F mm	143	186	143	186	250	143	186	250
Ø O mm	16,3	16,3	19,45	19,45	19,45	24,2	24,2	24,2
Thread-Ø M	M10	M10	M12	M12	M12	M16	M16	M16
Total length flange P	35	40	35	40	45	35	40	45